

SELF CONTAINED

VIEW-VS SERIES

DUAL TEMP VARIABLE SPEED ISLAND CABINETS



ENHANCED ENERGY EFFICIENCY
& VERSATILITY

HUSSmann
By **austral**



PRODUCT BENEFITS

- High vision dual temperature merchandiser with glass push-pull lids for greater customer interaction and product visibility
- Ergonomic design for easy product access
- Flexible shelving configurations to optimise merchandising
- Best visual impact for products with energy efficient LED lighting
- Low Total Energy Consumption to save on total energy costs
- Ensured product temperature compliance tested
- Designed for modular configurations to suit many store formats
- Small footprint with maximised display area
- Reinforced shelving to suit varied product weight
- Environmentally sustainable design using natural refrigerant
- Adjustable feet for easy levelling installation
- Easy plug-in on-site installation
- Low reflective E-coated glass for improved product visibility and temperature control
- Flexible dual temperature cabinet (LT and MT) that easily changes from freezer to chiller to provide optimised merchandising to meet customer demand
- Bottom front drainage opening for easy cleaning

STANDARD FEATURES

- External and internal food grade plasticised metal sheet finis
- Single horizontal front and rear mounted remote controlled colour adjustable LED lights (white/pink)
- Rubber bumper (black)
- Static refrigeration system with copper evaporator
- Digital controller with temperature display
- Ventilated condensing unit
- Variable speed compressor (inverter)
- Glass push-pull lids
- Automatic hot-gas defrost installed
- Four dividers and four shelves provided for each 2100 section
- Refrigerant: R290
- EC fan motors

CUSTOMISATIONS**SHELVING & BASE SHELF**

- Additional shelves and dividers
- Baskets

LIGHTING

- Additional rear mounted LED lighting available

OTHER

- Castors
- Zinc coated steel kickplate
- Rear metal joining kit for island configurations
- Alternative bumper colour options available
- External and internal colours available on request

ENERGY & SUSTAINABILITY

- Modbus ready

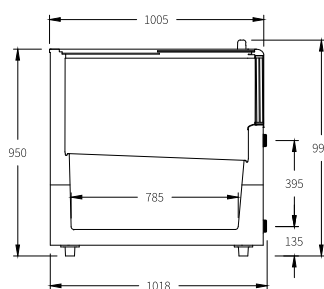

STANDARD
VIEW210-DTVS

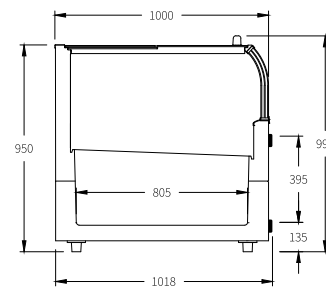

CROWN END
VIEW210C-DTVS

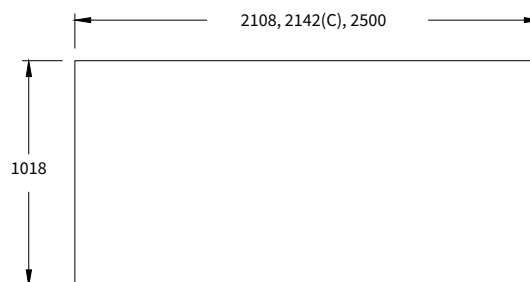

TECHNICAL DATA					
Code	Standard Depth 1018 mm	Standard Height 990 mm	VIEW210-DTVS	VIEW250-DTVS	VIEW210C-DTVS CROWN END
Total Length (mm)			2108	2508	2142
Net Volume (L)			672	878	672
Display Area (m2)			1.65	1.82	1.66
Amperage (amps)			1.79	2.1	1.95
Net Weight (kg)			180	211	198
Gross Weight (kg)			227	254	239

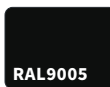
AVAILABLE COLOURS

DUAL TEMPERATURE CLASS	
3M1	3L1
(-1 °C to +5 °C)	(-18 °C to -15 °C)

Additional Information

All Dimensions shown in Millimetres (mm) unless otherwise stated. Dimensions and features are subject to change. Please obtain current technical information prior to order confirmation.

NOTE: We reserve the right to change or revise specifications and product design in connection with any feature of our products. Such changes do not entitle the buyer to corresponding changes, improvements, additions or replacements for equipment previously sold or Shipped.

**Hussmann Australia Head Office**

66 Glendenning Road, Glendenning NSW 2761 Australia
ph. +612 8805 0400
w. www.hussmann.com.au

HUSSmann
 By **austral**